

# SPECIFICATION

*PART NO. : LT632G-H204*

**2.9mm ROUND LED LAMP WITH HOLDER**



Approved by

Checked by

Prepared by

*SAN*

*Sunny*

*Angel*

**Package Dimensions**

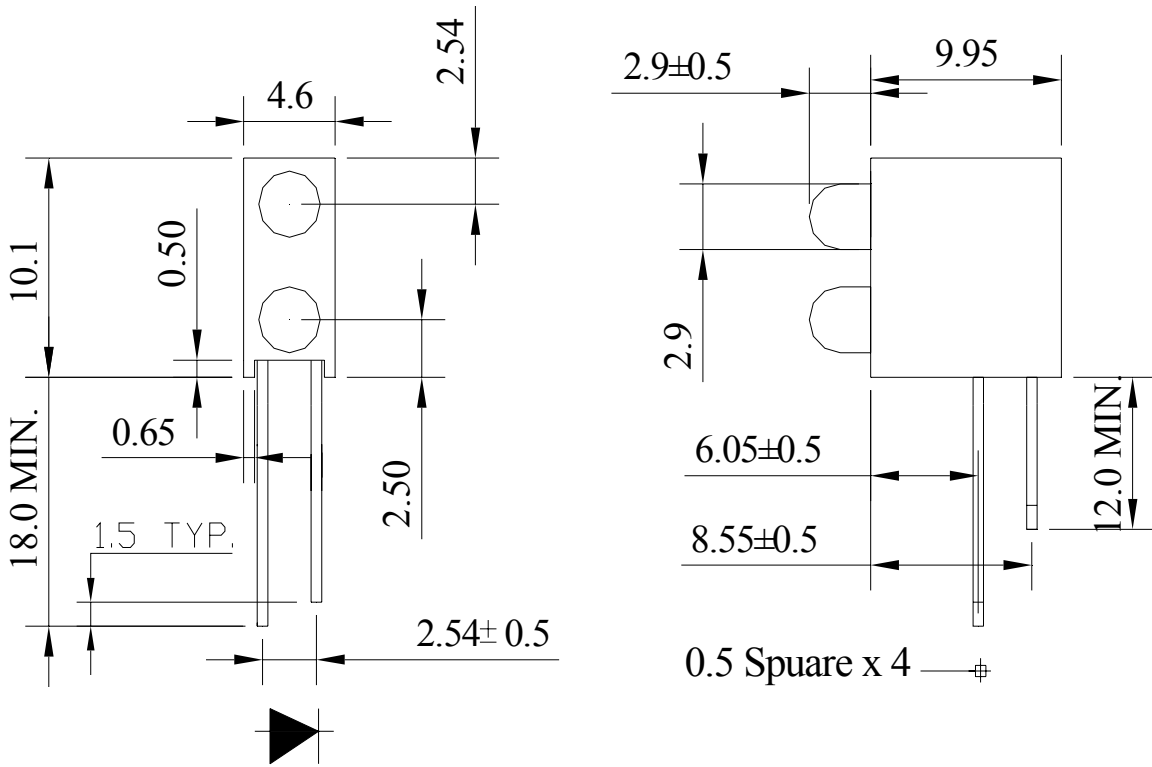

Notes:

1. All dimensions are in millimeters.
2. Tolerance is  $\pm 0.25$ mm unless otherwise noted.
3. The color of holder: Black.

**Description**

| Part No.    | LED Chip |                | Description    |
|-------------|----------|----------------|----------------|
|             | Material | Emitting Color |                |
| LT632G-H204 | GaP/GaP  | Green          | Green Diffused |

**LT632G-H204**2.9mm ROUND LED  
LAMP WITH HOLDER**Absolute Maximum Ratings at Ta=25 °C**

| Parameter                                      | Symbol                | Rating      | Unit |
|--|-----------------------|-------------|------|
| Power Dissipation                              | P <sub>D</sub>        | 78          | mW   |
| Reverse Voltage                                | V <sub>R</sub>        | 5           | V    |
| D.C. Forward Current                           | I <sub>f</sub>        | 30          | mA   |
| Peak Current(1/10Duty duty,0.1ms Pulse Width.) | I <sub>f</sub> (Peak) | 100         | mA   |
| Operating Temperature Range                    | T <sub>opr.</sub>     | -25 to +85  | °C   |
| Storage Temperature Range                      | T <sub>stg.</sub>     | -40 to +100 | °C   |

**Electrical and Optical Characteristics:**

| Parameter               | Symbol         | Condition            | Min. | Typ. | Max. | Unit |
|-------------------------|----------------|----------------------|------|------|------|------|
| Luminous Intensity      | I <sub>v</sub> | I <sub>f</sub> =20mA | 11.0 | 18.0 |      | mcd  |
| Forward Voltage         | V <sub>f</sub> | I <sub>f</sub> =20mA |      | 2.1  | 2.6  | V    |
| Peak Wavelength         | λ <sub>P</sub> | I <sub>f</sub> =20mA |      | 567  |      | nm   |
| Dominant Wavelength     | λ <sub>D</sub> | I <sub>f</sub> =20mA |      | 572  |      | nm   |
| Reverse Current         | I <sub>r</sub> | V <sub>r</sub> =5V   |      |      | 100  | μA   |
| Viewing Angle           | 2θ 1/2         | I <sub>f</sub> =20mA |      | 55   |      | deg  |
| Spectrum Line Halfwidth | Δλ             | I <sub>f</sub> =20mA |      | 30   |      | nm   |

NOTE:THE DATAS COME FROM THE SPEC. OF LT6321-41

**Typical Electrical/Optical Characteristic Curves**

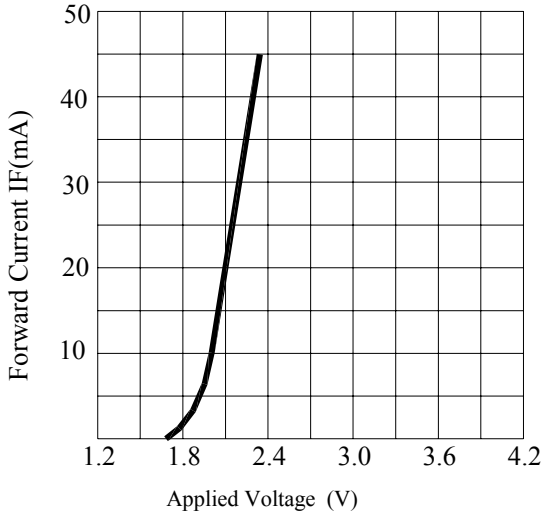

**FORWARD CURRENT VS. APPLIED VOLTAGE**

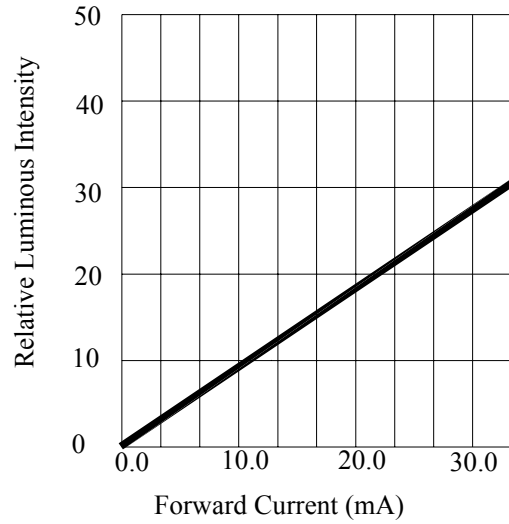

**FORWARD CURRENT VS. LUMINOUS INTENSITY**

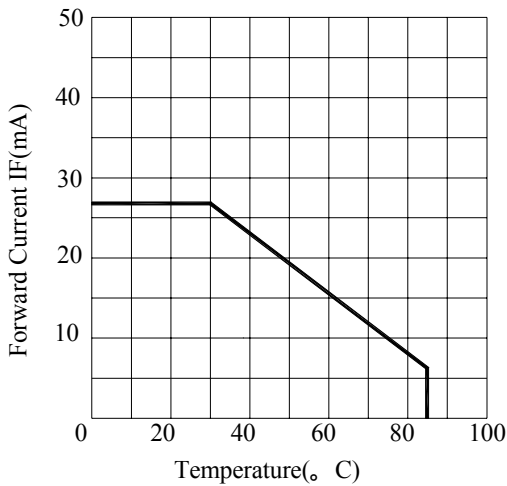

**FORWARD CURRENT VS. AMBIENT TEMPERATURE**

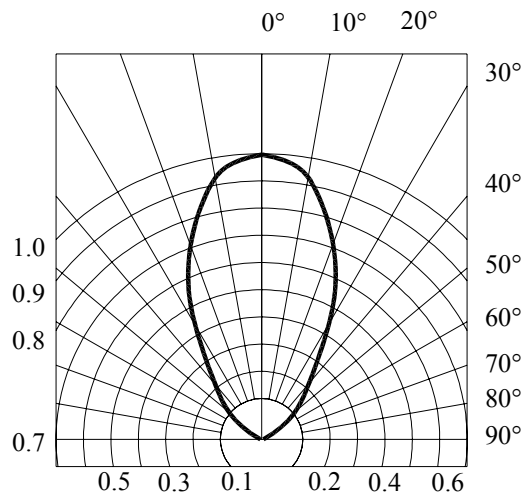

**RADIATION DIAGRAM**

**Precautions in Use:**

**Storage**

Recommend storage environment

Temperature : 5 ~30

**Soldering**

**Reflow Soldering**

Recommend use of upper and lower heater type reflow furnace.

300°C Max for up to 5 seconds.

Pre-heat is 150°C Max for up to 2 minutes Max.

In case of screen-printing, keep metal mask thickness between 0.2mm and 0.3mm.

**Manual Iron Soldering (NOT RECOMMENDED)**

Use SN60 solder of solder with silver content.

Use 25W soldering iron at 300°C Max for 5 seconds or less.

Must not touch top resin portion of lamp by heated soldering iron.

**Cleaning**

Surface condition of this device may change when organic solvents such as trichloroethylene or acetone were applied.

Avoid using organic solvent.

Recommend ultrasonic method 300W Max.

**Reflow Temp/Time:**

