

AC SOCKET

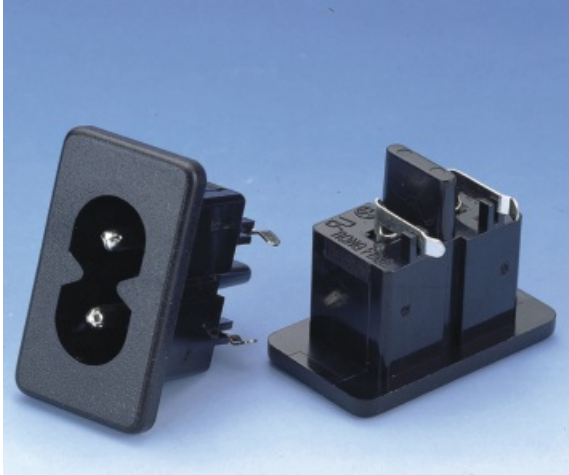

RF-180-COS

STANDARD: IEC 320 C8
RATING: 2.5A/250V AC
APPROVALS: UL/CSA/VDE/ÖVE/SEV/
DEMKO/NEMKO/SEMKO/FIMKO

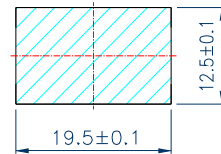
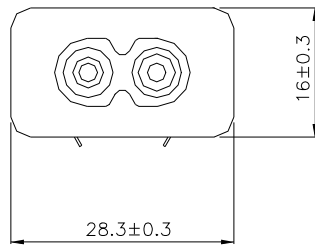

PANEL CUTOUT THICKNESS 0.6mm~2.0mm

