

A			
	新版图	/	2011.09.07
			LZW

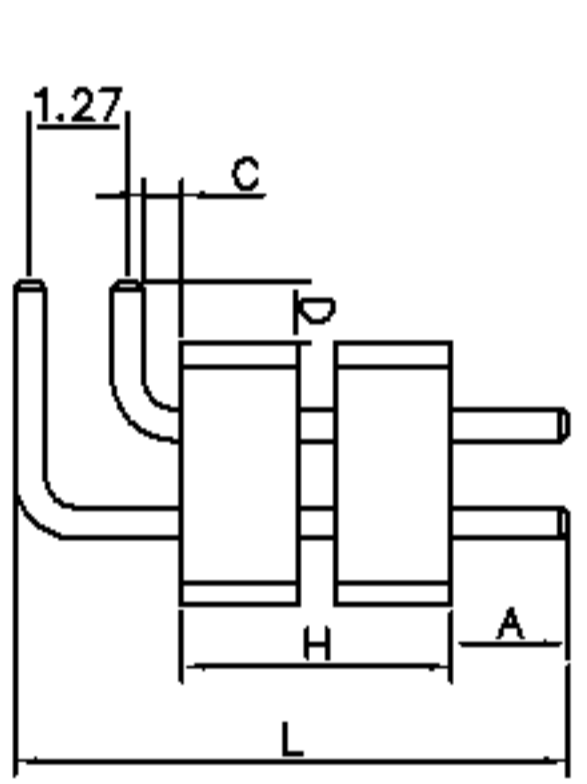

A、C、D、H、L的尺寸  
可依客户要求订做

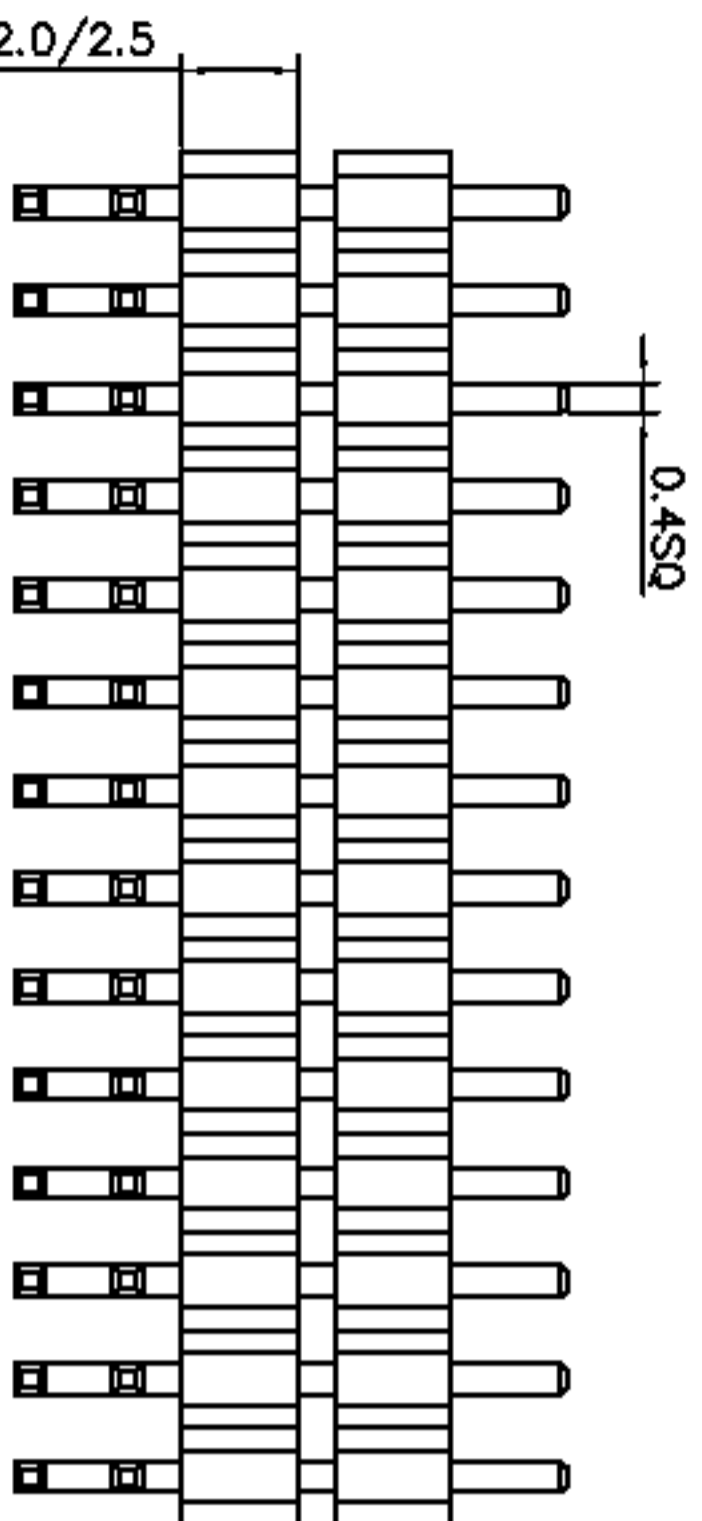
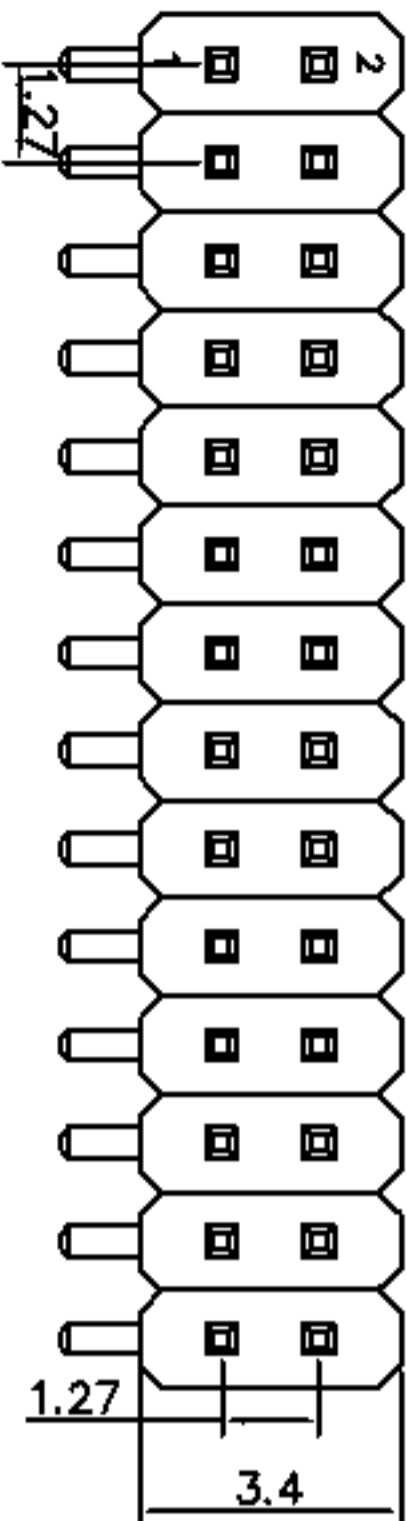
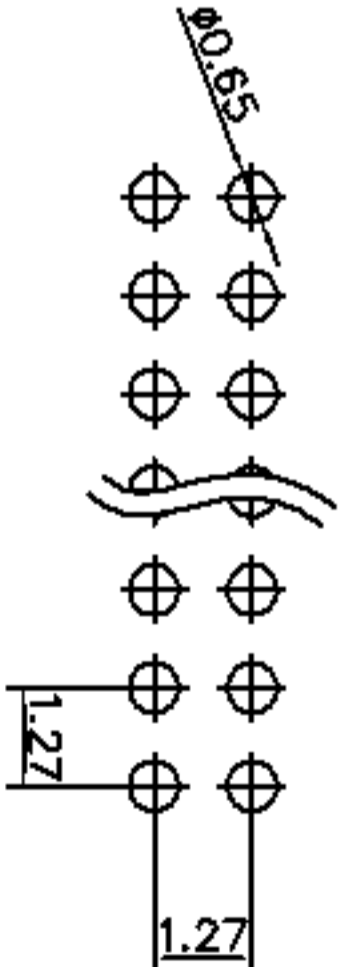

### PCB Layout

#### Specification:

- Current Rating: 1Ampere
- Insulation Resistance :1000M ohms Min.
- Dielectric Withstanding :300V AC
- Contact Resistance: 20m ohms Max.
- Operating temperature:-40° C to +105° C
- Material:
- Contact: Brass,Gold Flash or per Requirm
- Housing:Nylon6T UL 94V-0

1101-427R12XXB-H-L  
 1.27PIN距双塑胶双  
 排弯式排针系列  
 每排PIN数  
 两排针排距1.27  
 塑高  
 总高

TOLERANCE		ANGLE
TOL		
ON	0.05	
.XXX =	0.15	1°
XX =	0.20	2°
X -	0.30	

DRAWN	DATE	 武汉宇恒电子有限公司 WUHAN YUHENG ELECTRONIC CO., LTD
LZW	2011.09.07	
CHECKED	DATE	TITLE:
		排针系列-1.27*1.27PIN距-双排 双塑胶-弯式
CLIENT APPROVED	DATE	RFQ NO
		CLIENT P/N
		UNIT: mm
		SCALE: free
		FILE NO.: YH20120526A005