

REVISION DATA				
SYM	EON	DESCRIPTION	DATE	APPROVED

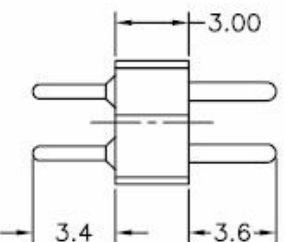
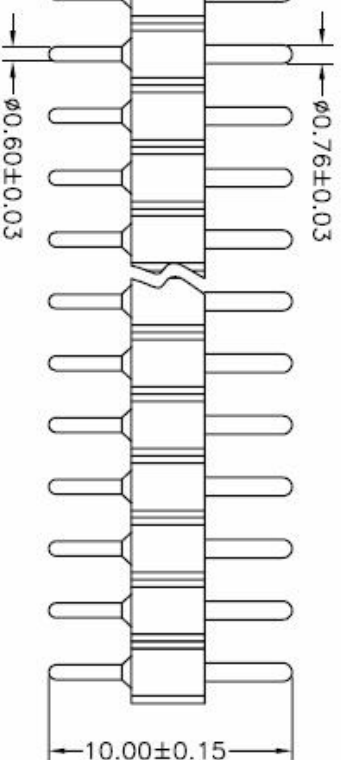
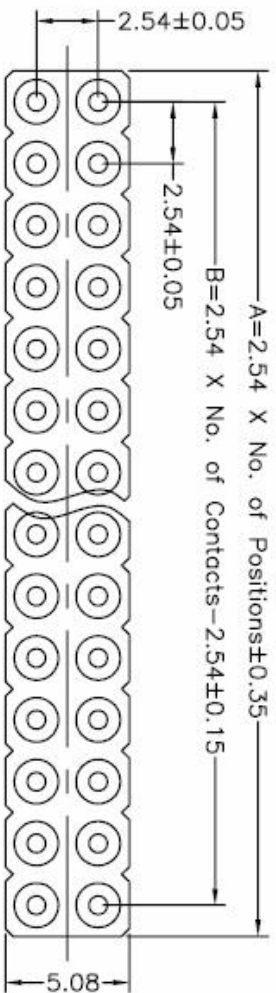

## Technical Data

Material:  
 Pin(outer sleeve): Brass,machined CuZn38Pb2  
 Plating(outer sleeve):  
 Tin plated:2µm/80µ"Ni, 5µm/200µ"Sn  
 Gold Plated:2µm/80µ"Ni,Full gold  
 Insulator(black): Black (PPS) UL94V-0

Electrical:  
 Current rating: 3Amps/contact max.  
 Contact resistance:  $\leq 4m\Omega$ /contact  
 Insulation resistance:  $\geq 5000M\Omega$  at V=500V  
 Dielectric Withstanding Voltage: 1000V AC Min  
 Operating voltage: 60VAC/DC

Mechanical:  
 Operating temperatures: Gold Plated:-55°C to+125°C  
 Tin plated:-40°C to+105°C  
 Soldering temperature: +260°C,10s max.

**ADD**

XX	X	X	X	X
No. of Positions 02 thru 40	Dip spacing Option 2 Double row	Insulator type 0 S/D row 1 Open frame 2 W/o bar	Pin Plating Option 1 Tin150µ" 2 Tin200µ" 3 G/F 4 Gold3µ" 5 Gold10µ" 6 Gold15µ" s Special	Pin length Option 1 10.00mm 2 11.96mm 3 13.70mm s Special

C

TOLERANCE:	PROJECTON	TITLE:
ANGLE ±5°	06-08-06'	2.54mmPitch SIP Adapters DIP
X.XXX ±0.05	DRAWN LIUJIE	DIP Spacing:2.54mm Pin Length 10.00mm
X.XX ±0.15	CHECKED	PART NO: ADDNXX031C
X.X ±0.20	APPROVED	DRAWING NO: NP-ADDNXX031C
X. ±0.35		REV: A UNIT: mm SCALE: 3:1 SIZE: A4