

REV.	NOTES	DATE
A	RELEASED	2004/06/25

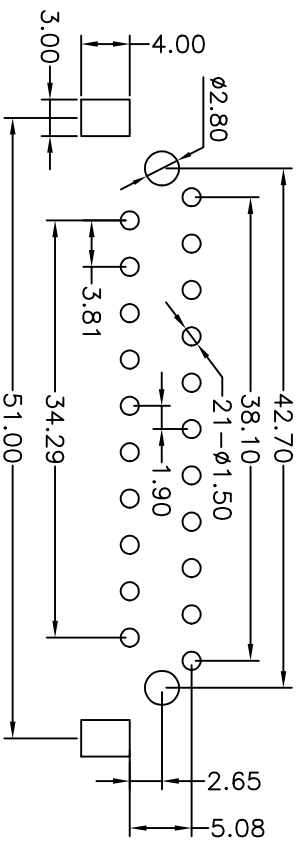
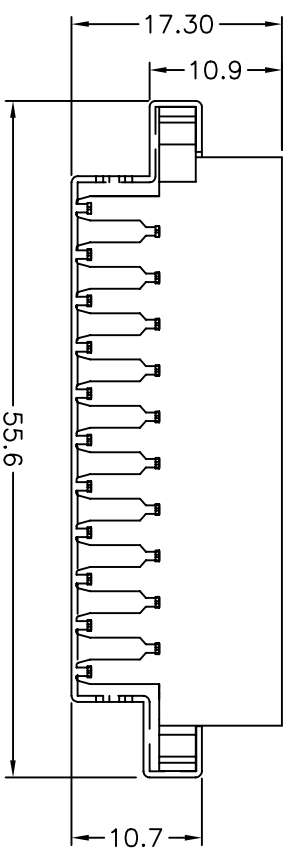
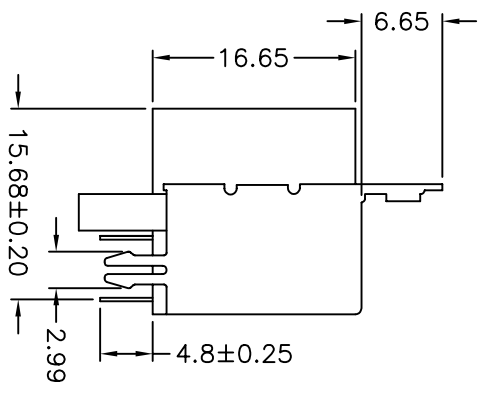
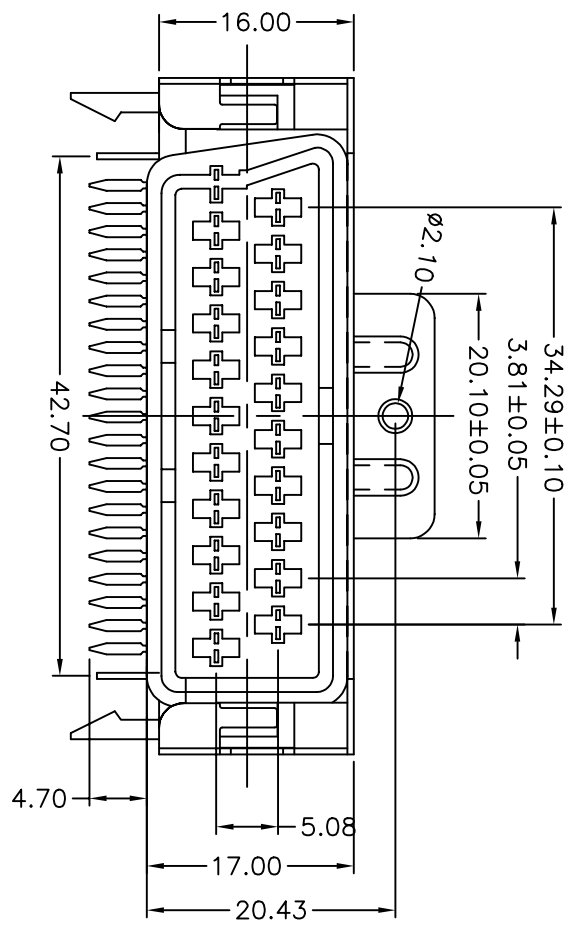

RECOMMEND P.C BOARD LAYOUT

- NOTES:
- MATERIALS
 - Insulator: Pc
 - Contact: Brass 0.3t, Gold plated
 - Sheet: SPCC 0.5t, Gold plated
 - SPECIFICATIONS
 - Current Rating: 3.0Amp
 - Dielectric Strength: 1000V AC for one minute
 - Insulator Resistance: 1000M Ohms Min.(at 500V DC)
 - Operation Temperature: -55 °C to +105°C

DIMENSIONS TOLERANCE		METRIC	
0 = ±.3		設計 (DE' N)	
.00 = ±.15		審核 (CH' K)	
.0000 = ±.XXX		核准 (APP' D)	
ANG. = ±2'			
單位 (UNITS)	mm	繪圖 (DRAW)	
數量 (QTY)	N/A	材料 (MT' L)	SEE NOTE
處理 (FINISH)	SEE NOTE	圖名 (NAME)	90度母座有柱有孔 PC 加鐵鍍(有凸)端子鐵鍍鍍全金
		料號 (PART NUMBER)	ASC+0350-10C1
		圖號 (DRAW NUMBER)	RASC035010C1
		圖檔 (FILE NAME .DWG)	E:GCT/A/SC/03
比例 (SCALE)	1/1	圖紙 (SHEET)	A4
		頁次 (SHEET)	1
		版次 (REV.)	A