

REV.	NOTES	DATE
A	RELEASED	2007/01/05

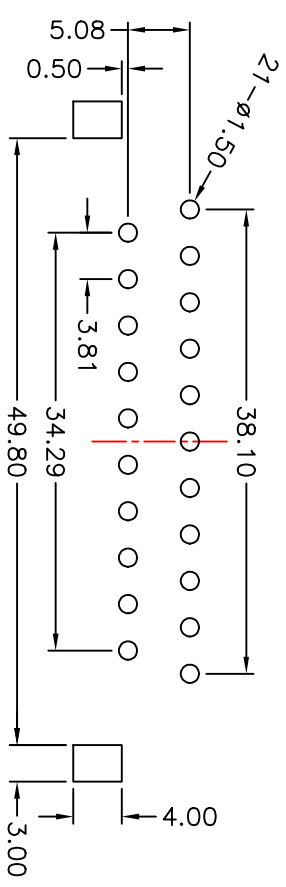
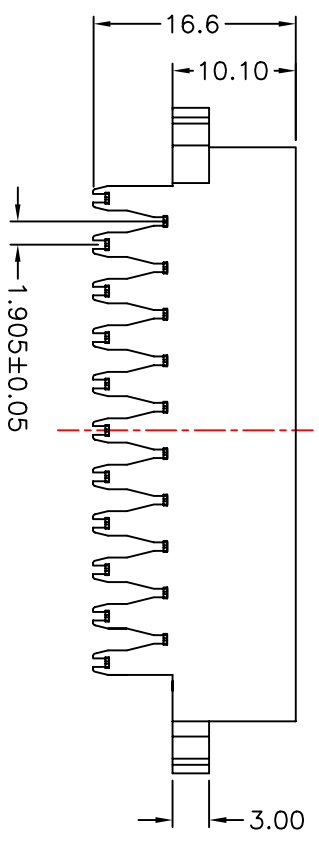
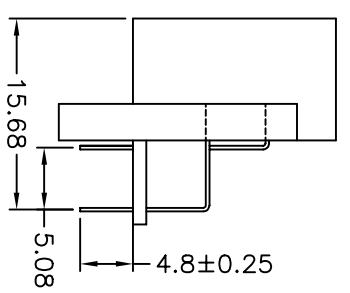
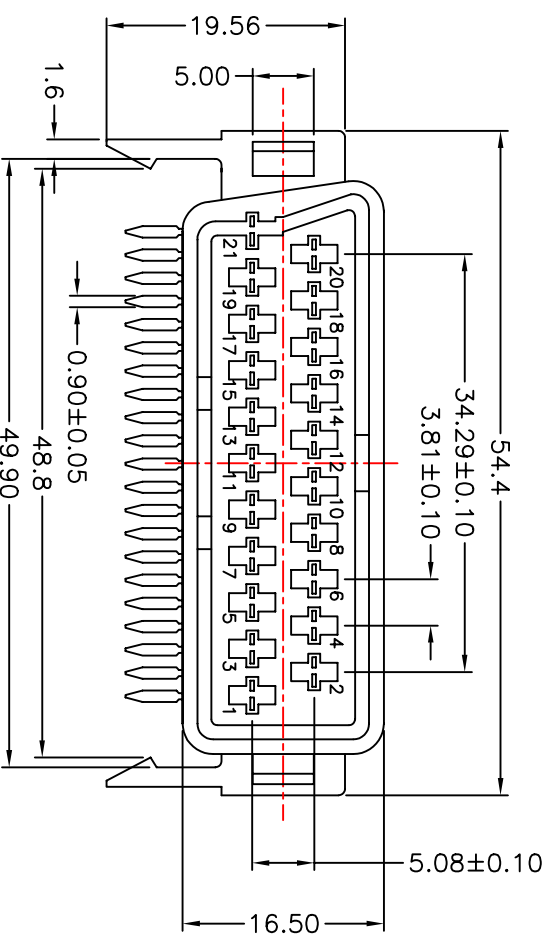

PCB LAYOUT

- NOTES:
- MATERIALS
 - Insulator: Pc
 - Contact: Brass
 - Contact Plating: Tin Plated
 - SPECIFICATIONS
 - Current Rating: 3 Amp
 - Contact Resistance: 25mΩ MAX
 - Dielectric Strength: 1000V AC for one minute
 - Insulator Resistance: 1000MΩ Min.(at 500V DC)
 - Operation Temperature: -55°C to +105°C

PART NO.	PLATING
ASC+0350-40C	TIN PLATED
ASC+0350-10C2	1U" GOLD PLATED
ASC+0350-30C	3U" GOLD PLATED
ASC+0350-40B	PBT加鍍7%無毒

單位 (UNITS)	mm
數量 (QTY)	N/A
材料 (MTR'L)	SEE NOTE
處理 (FINISH)	SEE NOTE

DIMENSIONS TOLERANCE

METRIC
 0 = ± .3
 .00 = ± .20
 .000 = ± .XXX
 .0000 = ± .
 ANG. = ± 2'

繪圖 (DRAW)		圖名 (NAME)	90度母座有柱有孔錫 PC			
設計 (DE'N)		料號 (PART NUMBER)	ASC+0350-40C	圖號 (DRAW NUMBER)	RSC035040C	
審核 (CHK'K)		圖檔 (FILE NAME .DWG)	E:GCT/A/SC/03	比例 (SCALE)	1/1	
核准 (APP'D)		圖紙 (SHEET)	A4	頁次 (SHEET)	1	
		版本 (REV.)			A	