

0.197" (5.00mm) Pitch Disconnectable Connectors With Anti-Misinertion Construction

1102 Series

SPECIFICATION

Poles: 1-6
 Voltage rating: AC, DC 250V
 Current rating: AC, DC, 5A
 Withstand voltage: 1500V AC/min.
 Insulation resistance: 1000M Ω /min.
 Temperature range: -25°C ~ +85°C
 Applicable PC board thickness: 0.063" (1.6mm)
 Contact resistance: Initial value/10m Ω max.
 After environmental testing/20m Ω max.



TERMINAL

Part No: 1102T
 Applicable wires: AWG#18-22
 Material: Brass
 Finish: Tin/plated
 Hardness: H
 Thickness: 0.25mm

TERMINAL 1102T

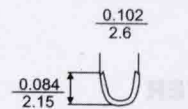
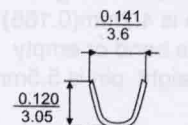
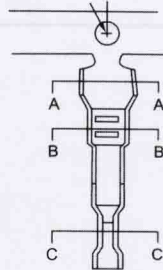

HOUSING

Part No: 1102H
 Poles: 1-6
 Material: Nylon 66, UL 94V-0

WAFER

Part No: 1102S(180°)
 Poles: 1-6
 Material: Post: Brass, Tin/plated
 Base: PBT or Nylon 66, UL 94V-0

Dimension: $\frac{\text{Inch}}{\text{mm}}$

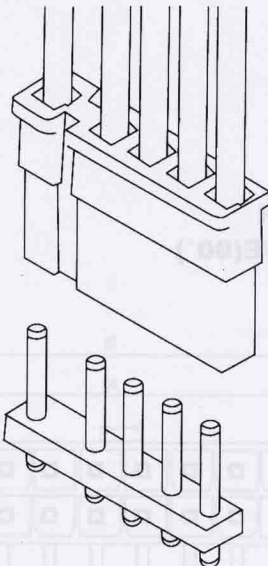
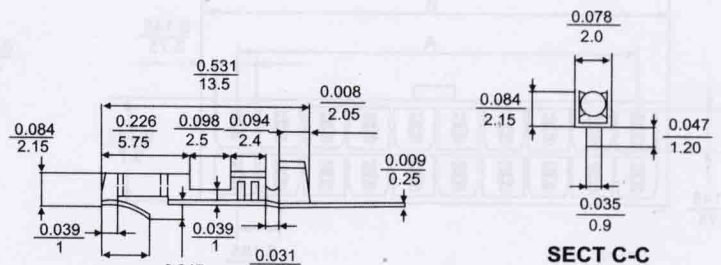

0.197" (5.00mm) Pitch Disconnectable Connectors With Anti-Misinertion Construction

1102 Series

HOUSING 1102H

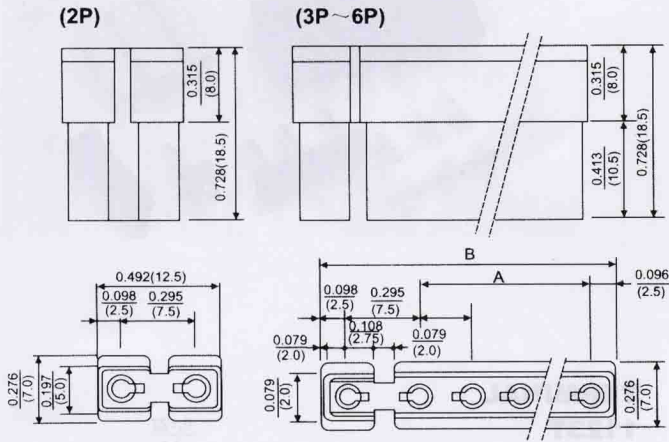

POLES	PART NO.	Dimension in.(mm)	
		A	B
1	1102H-1P		
2	1102H-2P		0.492(12.5)
3	1102H-3P	0.197(5.0)	0.689(17.5)
4	1102H-4P	0.394(10.0)	0.886(22.5)
5	1102H-5P	0.591(15.0)	1.803(27.5)
6	1102H-6P	0.787(20.0)	1.280(32.5)

BASE PIN ASSEMBLY 1102S(180°)

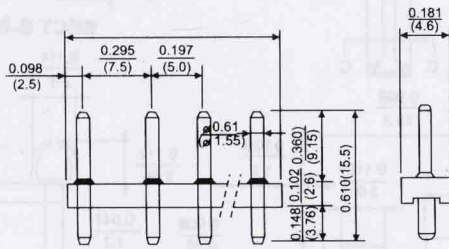

POLES	PART NO.	Dimension in.(mm)
1	1102S-1P	
2	1102S-2P	0.516(13.1)
3	1102S-3P	0.709(18)
4	1102S-4P	0.906(23)
5	1102S-5P	1.102(28)
6	1102S-6P	1.283(32.6)

PRINTED CIRCUIT BOARD LAYOUT AND ASSEMBLY LAYOUT

