

# PCB header strips connect 2.54mm

Single row/double row

Solder tail

Series: PHC

## PCB header strips for wiring application with solder tail / connecting pin

### Technical Specs:

Insulator: Black glass filled polyester PPS-GF30-FR  
 Flammability: UL 94V-O  
 Sleeve: Brass CuZn 36pb3(36000)  
 Mating pin Ø: 0.45 mm  
 Mechanical life: min 500 cycles  
 Rated current: 3 A  
 Contact resistance: max 10 mΩ  
 Dielectric strength: min 1000V RMS

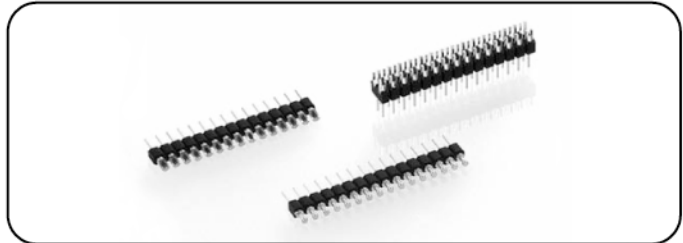

## Ordering information

PHC - NNN X - A P 1275A

No. of Positions	Insulator Type code	Pin Plating code
	1 Single row	1 Tin150μ"
	2 Double row	2 Tin200μ"
		3 GF
		4 Gold2μ"
		5 Gold3μ"
		6 Gold10μ"
		7 Gold15μ"
		S Special

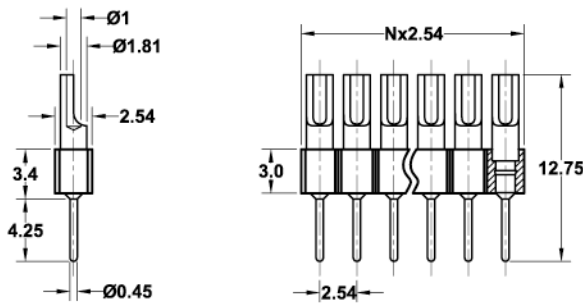

PHC-NNN1-AP1275A

Solder cup strip with wire-wrap termination: **single row**  
 Availability from: 2 to 40 contacts  
 Standard number of contacts 40

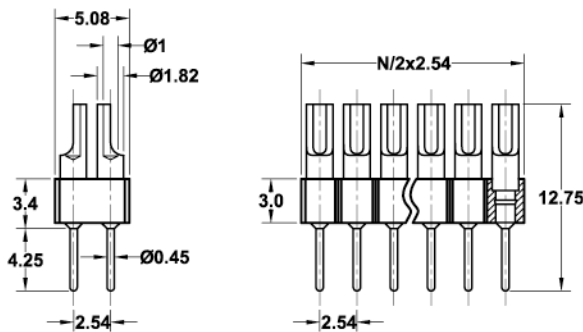

PHC-NNN2-BP1275A

Solder cup strip with wire-wrap termination: **double row**  
 Availability from: 4 to 80 contacts  
 Standard number of contacts 80

# Dual-in-line pin headers 2.54mm

Slotted head / turret / solder cup

Open frame

Solder tail

Series: PHC

## DIL pin headers for wiring applications

### Technical Specs:

Insulator:	Black glass filled polyester PBT-GF30-FR
Flammability:	UL 94V-O
Sleeve:	Brass CuZn 36pb3(36000)
Mating pin Ø:	0.5 mm
Mechanical life:	min 100 cycles
Rated current:	1 A
Contact resistance:	ma x 10 mΩ
Dielectric strength:	ma 1000V RMS

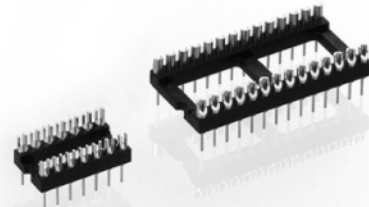

## Ordering information

PHC - NNN X - B P 1275A

No. of Positions	Row spacing code	Pin Plating code
	3 7.62mm	1 Tin150μ"
	4 10.16mm	2 Tin200μ"
	6 15.24mm	3 GF
	9 22.86mm	4 Gold2μ"
		5 Gold3μ"
		6 Gold10μ"
		7 Gold15μ"
		S Special

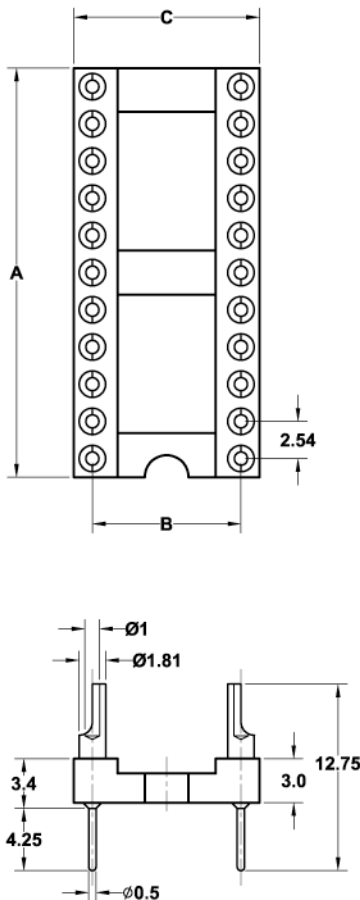

See page 46	No. of Positions	A	B	C	Order Codes
fig. 1	6	7.6	7.62	10.1	PHC-0063-BP1275A
fig. 2	8	10.1	7.62	10.1	PHC-0083-BP1275A
fig. 3	10	12.6	7.62	10.1	PHC-0103-BP1275A
fig. 4	12	15.2	7.62	10.1	PHC-0123-BP1275A
fig. 5	14	17.7	7.62	10.1	PHC-0143-BP1275A
fig. 6	16	20.3	7.62	10.1	PHC-0163-BP1275A
fig. 7	18	22.8	7.62	10.1	PHC-0183-BP1275A
fig. 8	20	25.3	7.62	10.1	PHC-0203-BP1275A
fig. 9	22	27.8	7.62	10.1	PHC-0223-BP1275A
fig. 10	24	30.4	7.62	10.1	PHC-0243-BP1275A
fig. 11	28	35.5	7.62	10.1	PHC-0283-BP1275A
fig. 12	20	25.4	10.16	12.6	PHC-0204-BP1275A
fig. 13	22	27.8	10.16	12.6	PHC-0224-BP1275A
fig. 14	24	30.4	10.16	12.6	PHC-0244-BP1275A
fig. 15	28	35.5	10.16	12.6	PHC-0284-BP1275A
fig. 16	32	40.6	10.16	12.6	PHC-0324-BP1275A
fig. 17	24	30.5	15.24	17.7	PHC-0246-BP1275A
fig. 18	28	35.5	15.24	17.7	PHC-0286-BP1275A
fig. 19	32	40.6	15.24	17.7	PHC-0326-BP1275A
fig. 20	36	45.7	15.24	17.7	PHC-0366-BP1275A
fig. 21	40	50.8	15.24	17.7	PHC-0406-BP1275A
fig. 22	42	53.3	15.24	17.7	PHC-0426-BP1275A
fig. 23	48	60.9	15.24	17.7	PHC-0486-BP1275A
fig. 24	50	63.5	15.24	17.7	PHC-0506-BP1275A
fig. 25	52	66.0	15.24	17.7	PHC-0526-BP1275A
fig. 26	50	63.5	22.86	25.3	PHC-0509-BP1275A
fig. 27	52	66.0	22.86	25.3	PHC-0529-BP1275A
fig. 28	64	81.2	22.86	25.3	PHC-0649-BP1275A