

1 2 3 4 5 6 7 8

A

B

C

D

A

B

C

D

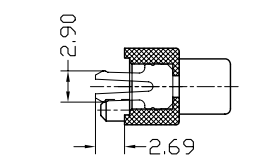

SECT C-C

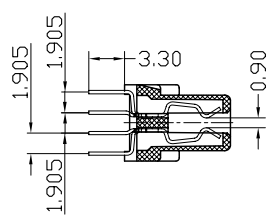

SECT B-B

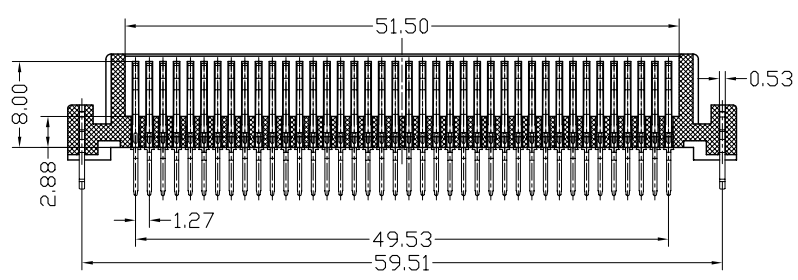
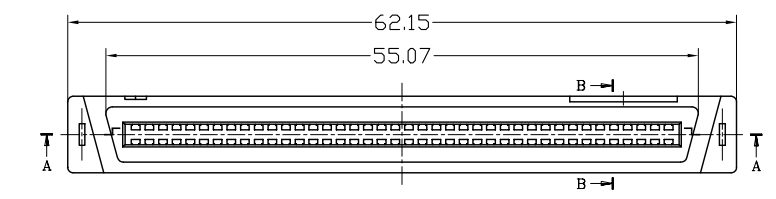

SECT A-A

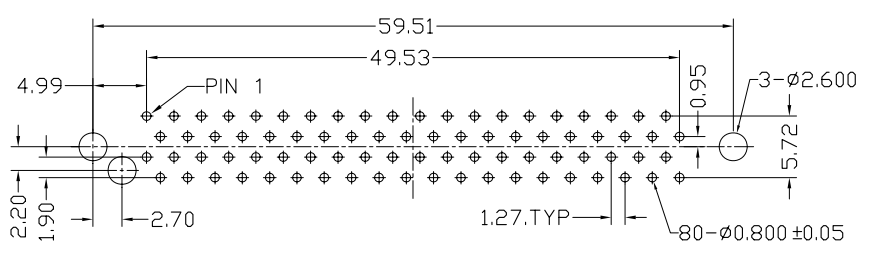
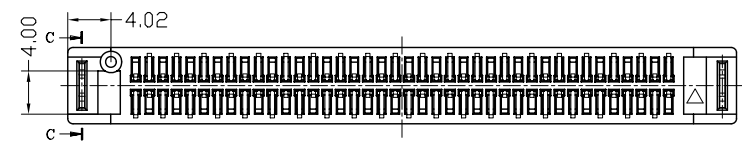

P.C.B LAYOUT  
TOP VIEW

**Notes:**

**\*Material**

Body : NYLON66+30%G.F or PBT+30%G.F,  
UL 94V-0 Rated.

Color: Black

Contacts : Phosphor Bronze

Plating: Gold plating over Nickel on contact  
area; Tin plating on Solder Tail.

**\*Mechanical:**

Insertion Force: 1.15N max per contact pair;  
Withdrawal Force: 0.15N min per contact pair;  
Contact Retention Force: 4.9N min per contact;

**\*Electrical Specification**

Contact Resistance : 35 Milliohms Max.

Current Resistance : 1. Ampere

Insulation Resistance : 500 Megohms Min, At 500V AC.

Operating Temperature : -55°c to +105°c

**\*How to order:**

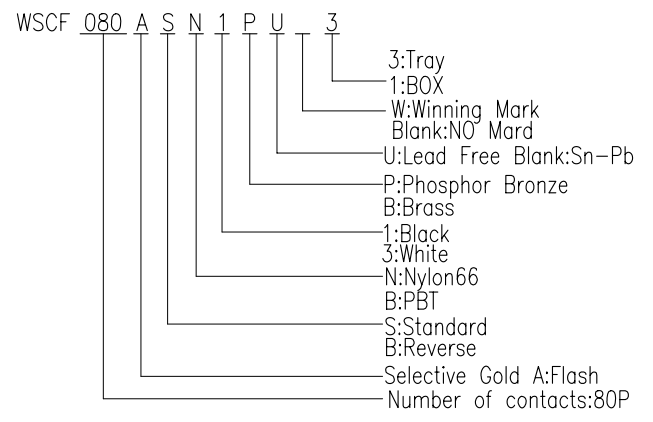

REV		Units		mm	Scale	1.6:1	Drawing By		Date	
Tolerance Unless Otherwise Specified							Reviewed By		Date	
.X		~		±0.38		Approval By		Date		
.XX		~		±0.25		Third Angle Projection		Date	Sheet	
.XXX		~		±0.20		Drawing No.		1 of 1	Title	
Angle		~		± 3°		REV		SCSI 2D SUB Female Strip Form Pin 80P (Standard)		

1 2 3 4 5 6 7 8