

用于直脚和弯脚焊接型引脚 (Applicable for straight and right angled solder pins)

09 Pin

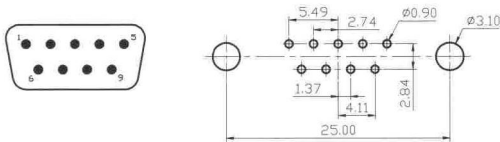

15 Pin

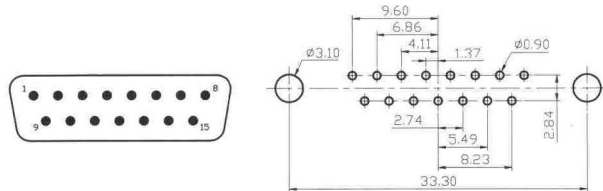

25 Pin

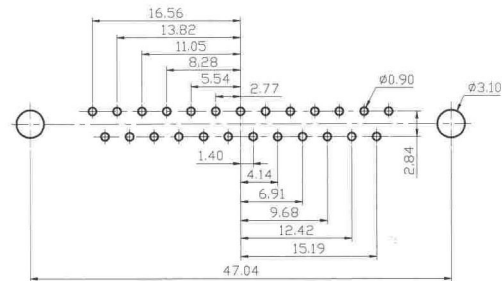
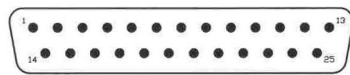

37 Pin

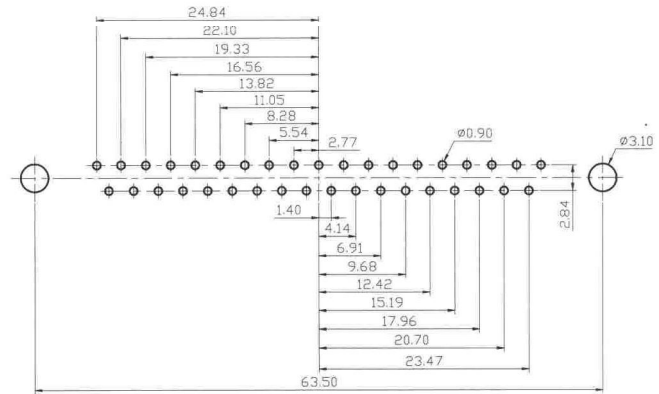
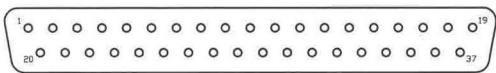

50 Pin

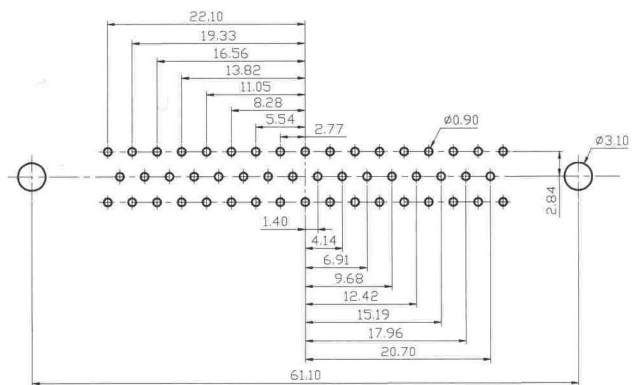
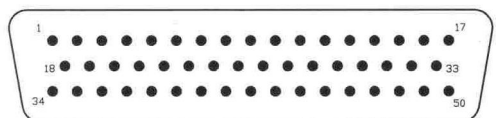

用于高密度直脚和弯脚焊接型引脚 (Applicable for high density straight and right angled solder pins)

15 Pin

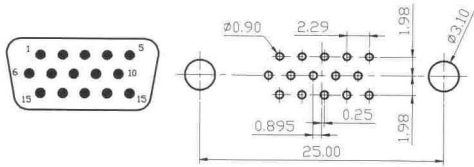

25 Pin

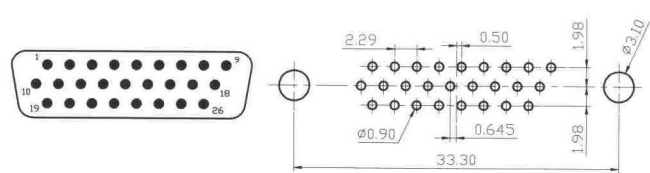

44 Pin

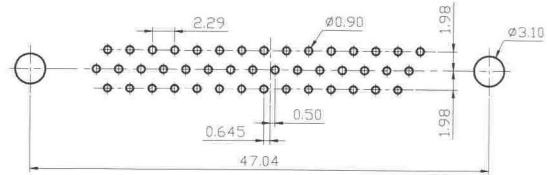
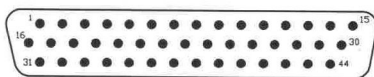

62 Pin

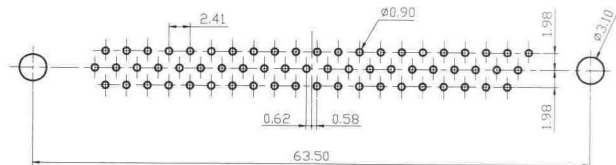
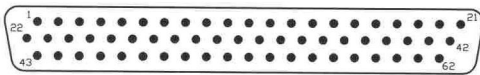

78 Pin

